

# SHELBOURNE

— ESTATES —



## The Dursley

---

From the open plan kitchen/dining room, with French doors out to the garden, through to the en-suite master bedroom, the Dursley has been thoughtfully designed with modern living in mind. Plus, as all Shelbourne Estates homes come with high quality specification as standard it's also a home you'll love for many years to come.

### 3 Bedrooms

919 TOTAL SQ FT

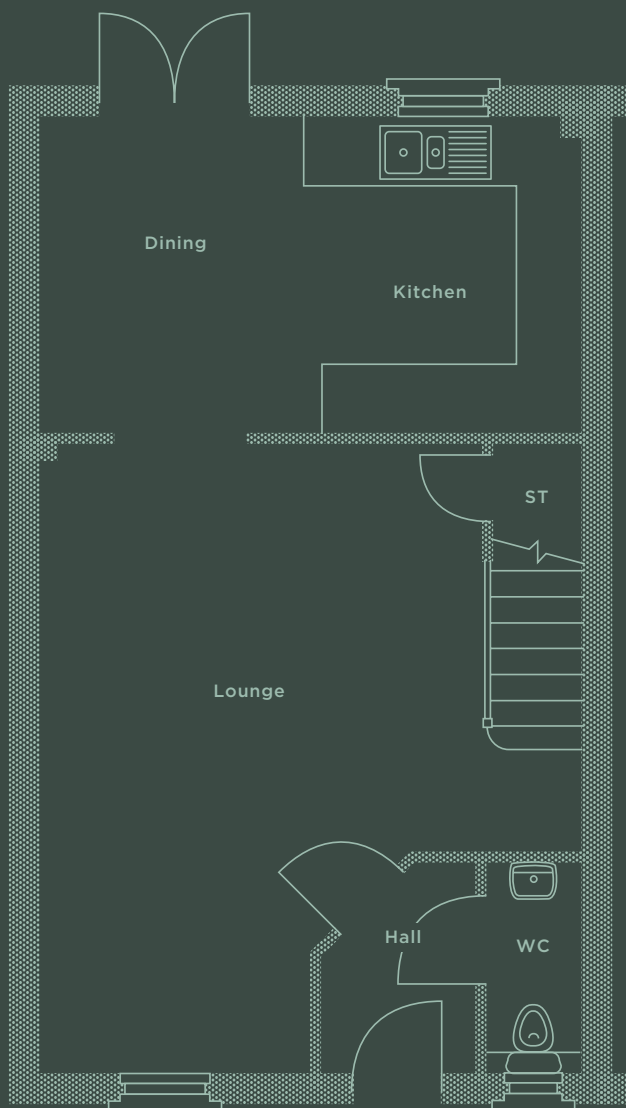

## Downstairs

Kitchen/Dining	4850 x 2805mm 15'11" x 9'2"
Lounge	5845* x 4850*mm 19'2"* x 15'11"*
Cloaks/WC	1850 x 855mm 6'1" x 2'11"

## Upstairs

Bedroom 1	2800 x 3485mm 9'2" x 11'5"
En-suite	2800 x 1200mm 9'2" x 3'11"
Bedroom 2	2800* x 3940mm 9'2"* x 12'11"
Bedroom 3	2295 x 3140*mm 7'6" x 10'4"*
Bathroom	1960 x 1845mm 6'5" x 6'1"

\*Denotes maximum room dimensions.

