

SHELBOURNE

— ESTATES —



The Cadley

The standout appearance of The Cadley is matched only by its superb interior, boasting all the space, style and thoughtful features required for harmonious, modern family living.

4 Bedrooms

1,358 TOTAL SQ FT

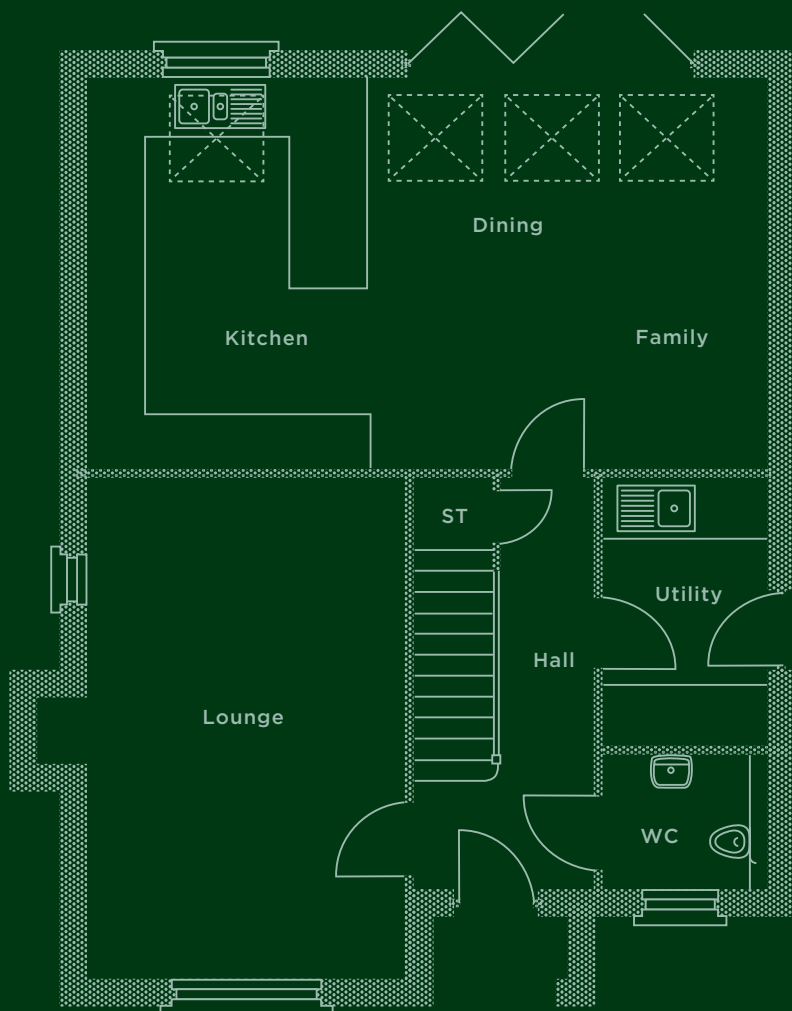

Downstairs

Lounge	3450 x 5450mm 11'4" x 17'11"
Kitchen/ Family/Dining	7430 x 4275mm 24'5" x 14'0"
Utility	1750 x 2875mm 5'9" x 9'5"
Cloaks/WC	1750 x 1425mm 5'9" x 4'8"

Upstairs

Bedroom 1	4230 x 4860*mm 13'11" x 15'11"*
En-suite	2425 x 1595mm 7'11" x 5'3"
Bedroom 2	3115* x 3860mm 10'3"* x 12'8"
Bedroom 3	2605* x 2825*mm 8'7"* x 9'3"*
Bedroom 4	2425 x 2860mm 7'11" x 9'5"
Bathroom	2225 x 1850mm 7'4" x 6'1"

*Denotes maximum room dimensions.

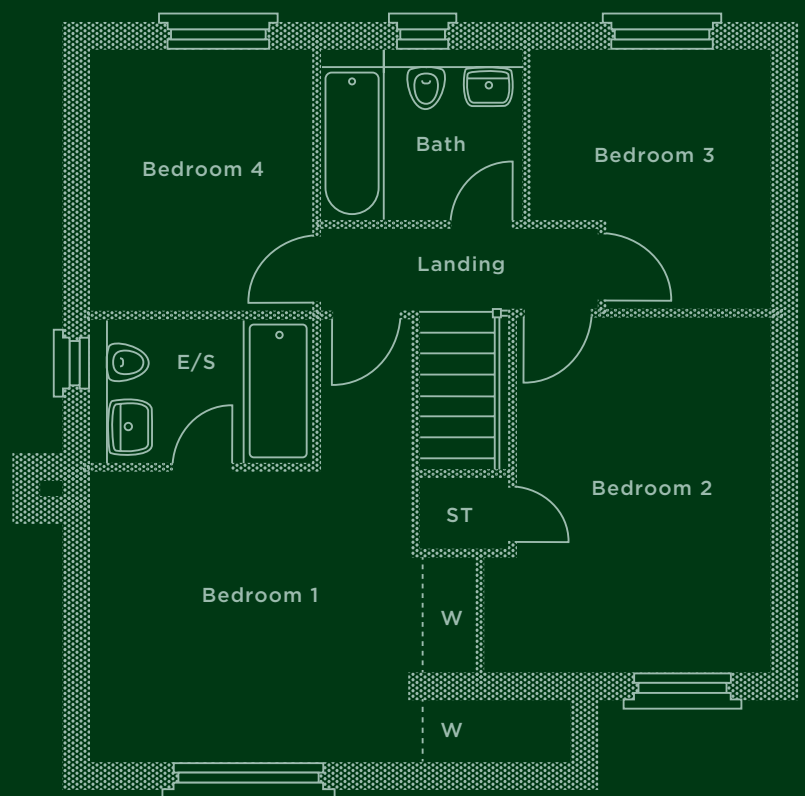

This is a computer generated image of The Cadley, elevation treatment may vary. All internal images are indicative of a Shelbourne house type. Room sizes are approximate and floorplans are not to scale. Plots may be handed and any garages may be single or double. Kitchen and bathroom layouts are indicative. These plans are correct at time of going to press, but may be subject to change during construction. Please ensure that you check for specific plot details. Speak to our Sales Advisor for individual parking configurations.