

# SHELBOURNE

— ESTATES —



## The Dorchester

---

A traditional home for the growing family, complimented by a contemporary interior and high specification, The Dorchester is a delightful property anyone would be proud to call their own.

### 3 Bedrooms

948 TOTAL SQ FT

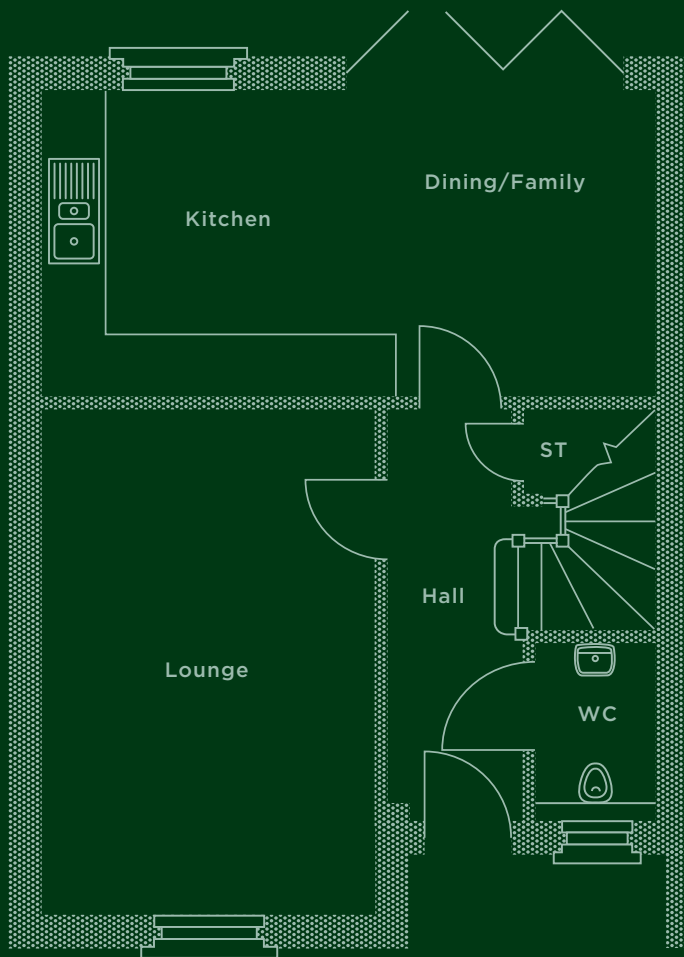

## Downstairs

Lounge	3150 x 4810mm 10'4" x 15'9"
Kitchen/Dining	5825 x 2890mm 19'1" x 9'6"
Cloaks/WC	1150 x 1710mm 3'9" x 5'7"

## Upstairs

Bedroom 1	3150 x 3585mm 10'4" x 11'9"
En-suite	3165 x 895mm 10'5" x 2'11"
Bedroom 2	3165 x 3190mm 10'5" x 10'6"
Bedroom 3	2575 x 2940*mm 8'5" x 9'8"*
Bathroom	2575 x 1710mm 8'5" x 5'7"

\*Denotes maximum room dimensions.

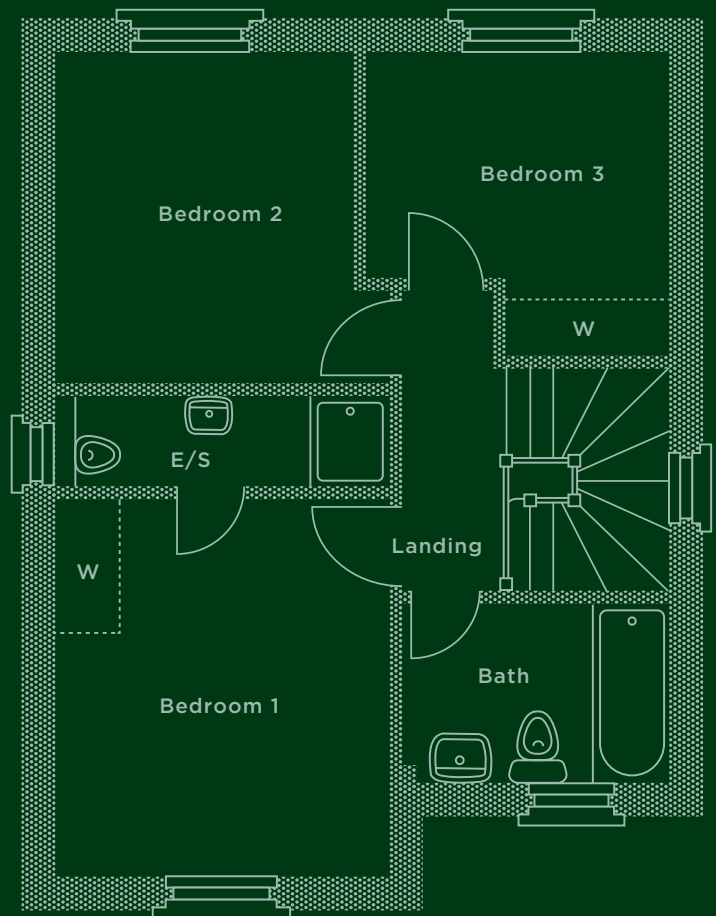

This is a computer generated image of The Dorchester, elevation treatment may vary. All internal images are indicative of a Shelbourne house type. Room sizes are approximate and floorplans are not to scale. Plots may be handed and any garages may be single or double. Kitchen and bathroom layouts are indicative. These plans are correct at time of going to press, but may be subject to change during construction. Please ensure that you check for specific plot details. Speak to our Sales Advisor for individual parking configurations.