

# SHELBOURNE

— ESTATES —



## The Saunderton

Blending traditional charm and architecture with an impressive entrance hall and a generous open plan kitchen area, spacious, contemporary interior, combined with living areas that flow seamlessly throughout, creating wonderful entertaining spaces and everything you look for in the family home of today, and more.

5 Bedrooms

2,162 TOTAL SQ FT

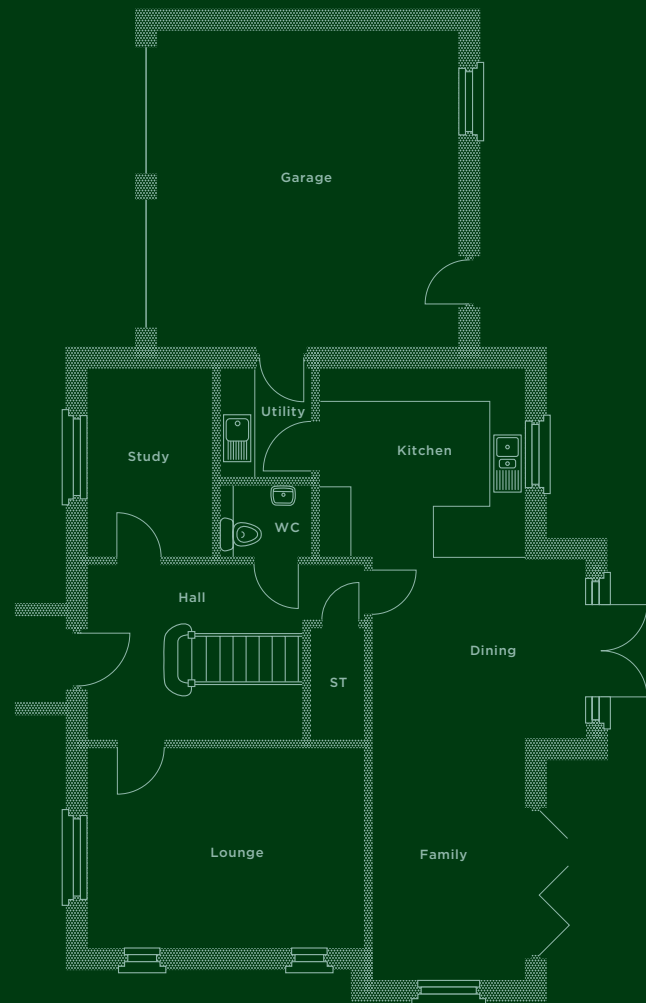

## Downstairs

Lounge	3575 x 4860mm 11'9" x 15'11"
Kitchen	3395 x 3710mm 11'2" x 12'2"
Utility	1975 x 1550mm 6'6" x 5'1"
Dining	3280 x 3840mm 10'9" x 12'7"
Family	4280 x 2765mm 14'0" x 9'1"
Study	3395 x 2215mm 11'2" x 7'4"
Garage	5610 x 5400mm* 18'5" x 17'9"*

## Upstairs

Bedroom 1	3910* x 5350mm 12'10"* x 17'7"
En-suite	1780* x 2365mm 5'10"* x 7'9"
Dressing	1780 x 2290mm 5'10" x 7'6"
Bedroom 2	3990* x 4525*mm 13'1"* x 14'-10"*
En-suite	1450* x 2825*mm 4'9"* x 9'3"*
Bedroom 3	3440 x 3160mm 11'3" x 10'5"
Bedroom 4	3440 x 3715*mm 11'3" x 12'2"*
Bedroom 5	3555 x 2820mm 11'8" x 9'3"
Bathroom	2345 x 2823mm 7'8" x 9'3"

\*Denotes maximum room dimensions.

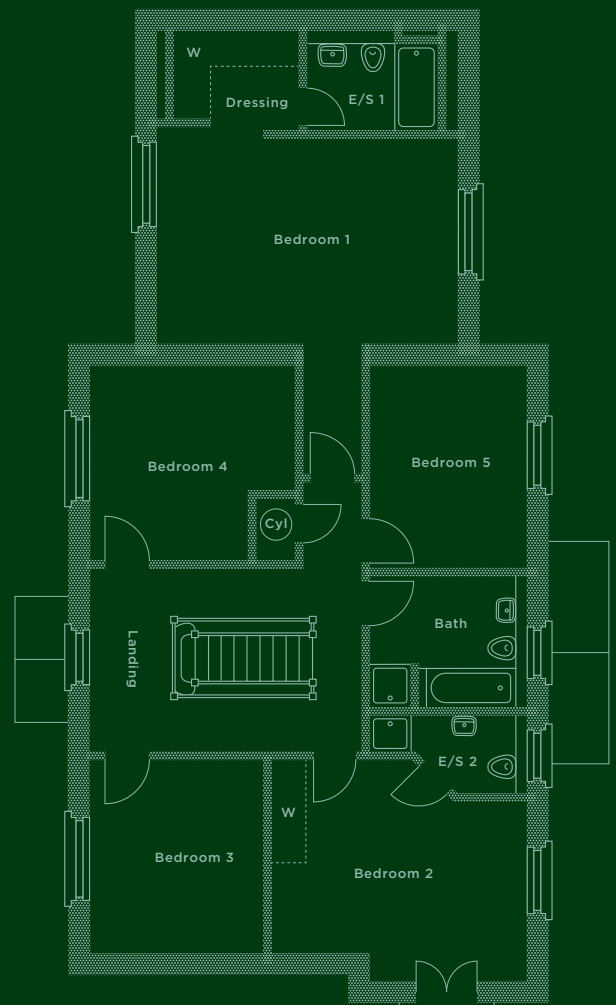

This is a computer generated image of The Saunderton, elevation treatment may vary. All internal images are indicative of a Shelbourne house type. Room sizes are approximate and floorplans are not to scale. Plots may be handed and any garages may be single or double. Kitchen and bathroom layouts are indicative. These plans are correct at time of going to press, but may be subject to change during construction. Please ensure that you check for specific plot details. Speak to our Sales Advisor for individual parking configurations.