

# SHELBOURNE

— ESTATES —



## The Wimborne

---

The Wimborne rises above other family homes to offer unrivalled space and style.

The innovative layout of this four bedroom home gives the whole family the flexibility to live life just how they choose.

4 Bedrooms

1,796 TOTAL SQ FT

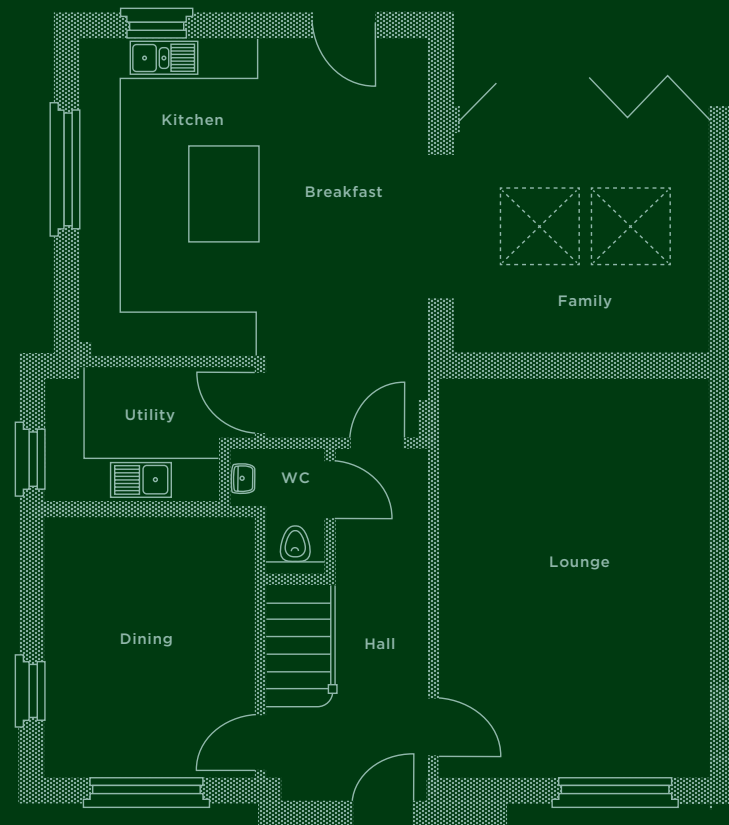

## Downstairs

Lounge	3770 x 5650mm 12'4" x 18'6"
Kitchen/ Breakfast	4905 x 5595*mm 16'1" x 18'4"*
Utility	2950* x 1950mm 9'8"* x 6'5"
Dining Room	2950 x 3650mm 9'8" x 12'0"
Family Room	3520 x 3125mm 11'7" x 10'3"
Cloaks/WC	1360* x 1780*mm 4'6"* x 5'10"*

## Upstairs

Bedroom 1	4905* x 5265*mm 16'1"* x 17'3"*
En-suite	1195 x 2615mm 3'11" x 8'7"
Bedroom 2	3255* x 3600mm 10'8"* x 11'10"
Bedroom 3	3830 x 2780mm 12'7" x 9'1"
Bedroom 4	3830* x 2780*mm 12'7"* x 9'1"*
Bathroom	3010 x 1965mm 9'11" x 6'5"

\*Denotes maximum room dimensions.

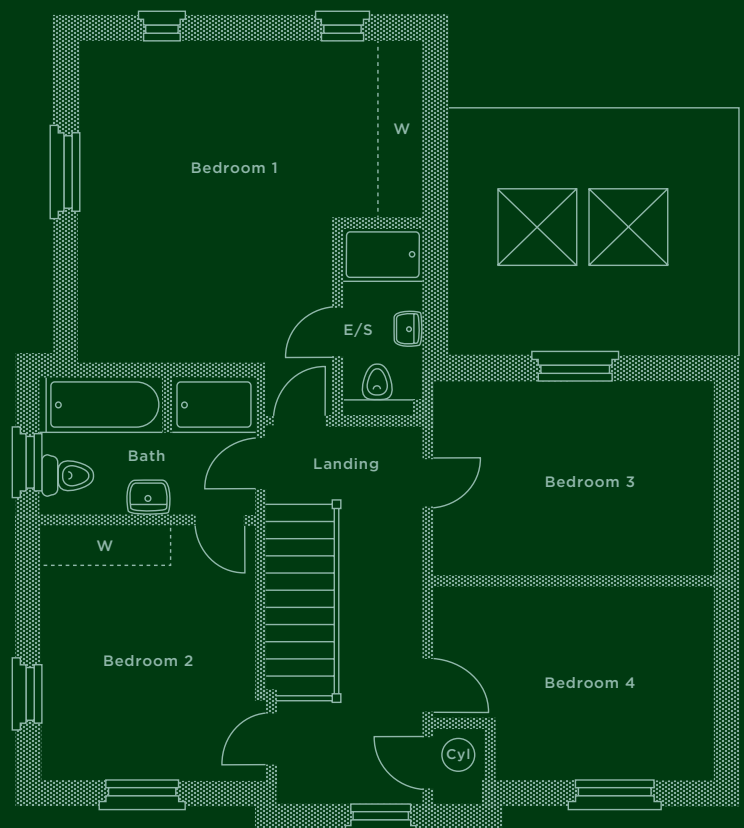

This is a computer generated image of The Wimborne, elevation treatment may vary. All internal images are indicative of a Shelbourne house type. Room sizes are approximate and floorplans are not to scale. Plots may be handed and any garages may be single or double. Kitchen and bathroom layouts are indicative. These plans are correct at time of going to press, but may be subject to change during construction. Please ensure that you check for specific plot details. Speak to our Sales Advisor for individual parking configurations.